

RTD Temperature Sensor - RTD-PM/PMXP

MSCP's RTD-PM/PMXP pipe mounted resistance temperature detectors are suitable for temperatures up to 850°C (1562°F). They are typically used for monitoring and controlling systems which require accurate temperature control. They are approved for use in non-hazardous and hazardous locations.

General Purpose



Class I, Div. II, Gr. A, B, C, D
Class II, Div. II, Gr. F, G

Explosion Proof



Class I, Div. I, Gr. B, C, D
Class II, Div. I, Gr. E, F, G
Class III



Type RTD-PM/PMXP

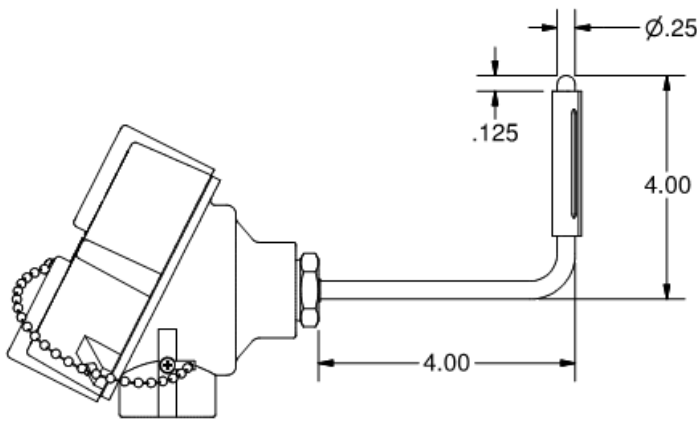

General Information

Specifications

- Minimum temperature range -200°C (-328°F)
- Maximum temperature range 850°C (1562°F)
- 100 Ohm resistance at 0°C
- Temperature coefficient of 0.00385 ohms/ohm/°C
- Available in 3 and 4 wire
- Cast Aluminum housing (RTD-PM)
- Cast Aluminum Teflon Coated housing (RTD-PMXP)
- 3/4 inch conduit hub required for connection